

# INSTRUKCJA MONTAŻU

Narzędzia potrzebne do montażu

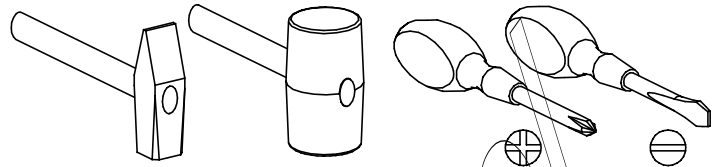

# SMYK "5"- REGAŁ 80'

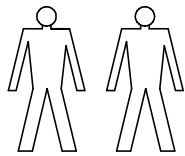
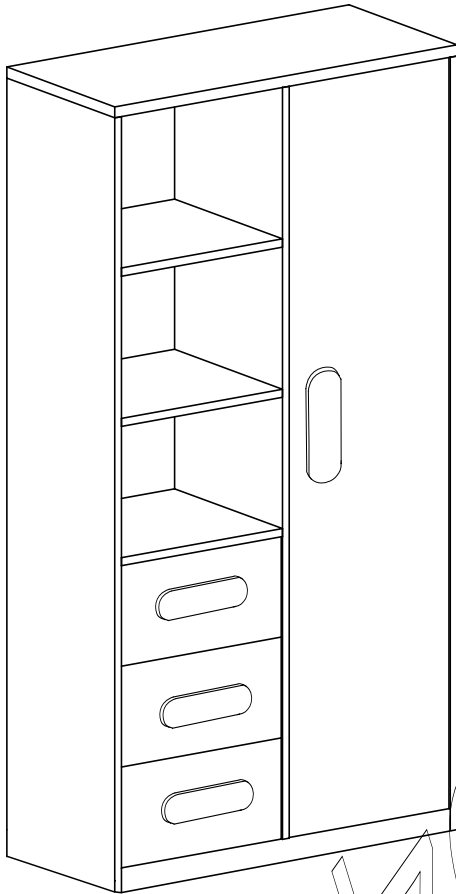

**UWAGA !**  
**PRZED PRZYSTĄPIENIEM DO**  
**MONTAŻU MEBLA PROSIMY**  
**DOKŁADNIE ZAPOZNAĆ SIĘ Z**  
**INSTRUKCJĄ MONTAŻU.**  
**USZKODZENIA POWSTAŁE W**  
**WYNIKU NIEPRAWIDŁOWEGO**  
**MONTAŻU NIE BĘDĄ UWZGLĘDNIONE**  
**PODCZAS REKLAMACJI.**

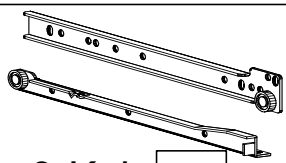

3-Kpl **H**

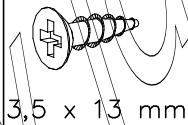

3,5 x 13 mm 12-St **J**



4-St **S**

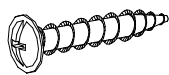

4 x 27 mm 8-St **N**

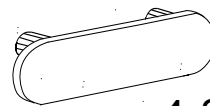

4-St **U**

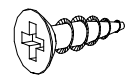

4 x 16 mm 18-St **G**

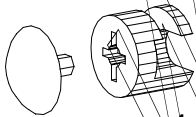

16-St **L**

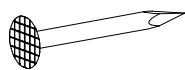

40-St **E**

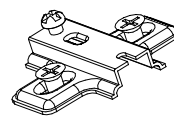

3-St **C**

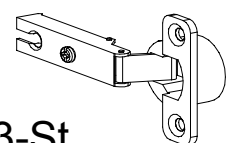

3-St **D**



1-St

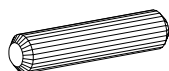

44-St **B**

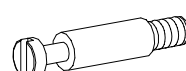

16-St **K**

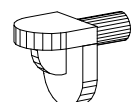

20-St **Z**